

NABIC®

HIGH LIFT STAINLESS STEEL SAFETY VALVE

Fig 500

APPLICATIONS

The Stainless Steel version of the Fig. 500 High Lift Safety Valve has been specifically developed for use where difficult fluids or gases are encountered. It's anti-corrosion properties, high discharge capacities and excellent seat tightness make it an ideal valve for these applications.

For other specific technical requirements refer to drawing 705 or consult the NABIC technical department.



BODY MATERIAL: 316 STAINLESS STEEL

MAXIMUM SET PRESSURE: 11 bar

MAXIMUM TEMPERATURE: 195 deg C

CONSTRUCTION

The valve is manufactured from 316 stainless steel and fitted with the proven NABIC resilient PTFE to metal seating design. To improve flow, the internal surface finish of the body is maintained at a high level by utilising the latest investment casting techniques. The unique design allows routine maintenance checks to be carried out with the valve in situ. Installation problems at site are reduced by NABIC offering and configuration of flange or screwed connections, the outlet connection being one size larger than the inlet.

Fig 500FS

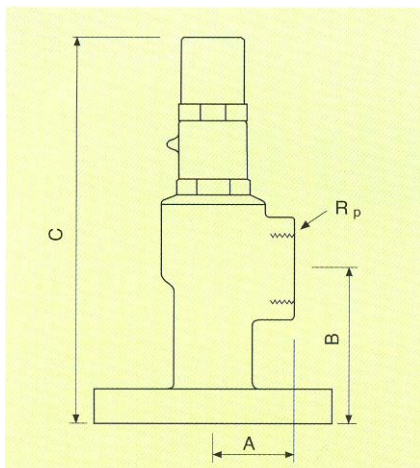

DIMENSIONS

SIZE DN	Rp BSP	A mm	B mm	C mm
15	3/4	33	75	170
20	1	39	75	179
25	1 1/4	45	75	197

Fig 500FF

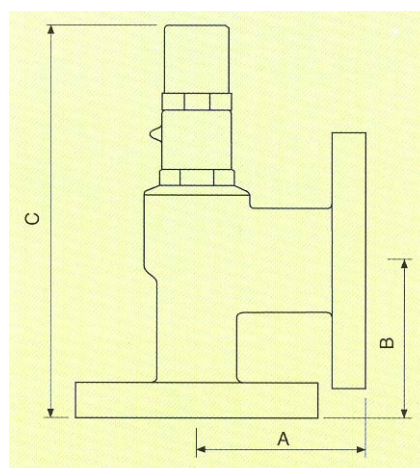

DIMENSIONS

SIZE DN	A mm	B mm	C mm
15	80	75	170
20	80	75	179
25	90	75	197

Fig 500FN

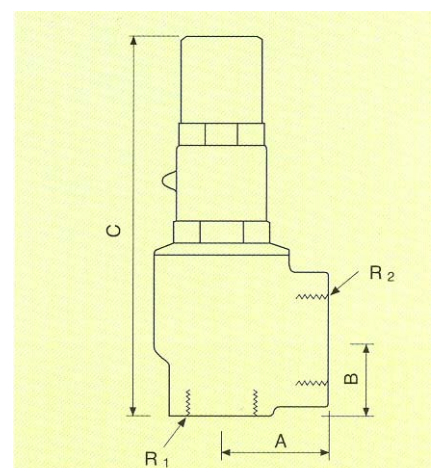

DIMENSIONS

SIZE DN	R1 BSP	R2 BSP	A mm	B mm	C mm
15	1/2	3/4	33	24	119
20	3/4	1	39	28	132
25	1	1 1/4	45	35	157

NABIC®